

MARITIME PROGRESS LTD

PHOTOLUMINESCENT PATH WAY MATTING

Mat Size 610mm x 2400mm TELBAK Flexible black PVC matting, incorporating Telglow Class B photoluminescent broken line marking to enhance path way finding. ORDER CODE: 2352

Normally this is laid in walk ways but can be used in front of equipment to alleviate operator fatigue and identify machine positions in the event of a black out.

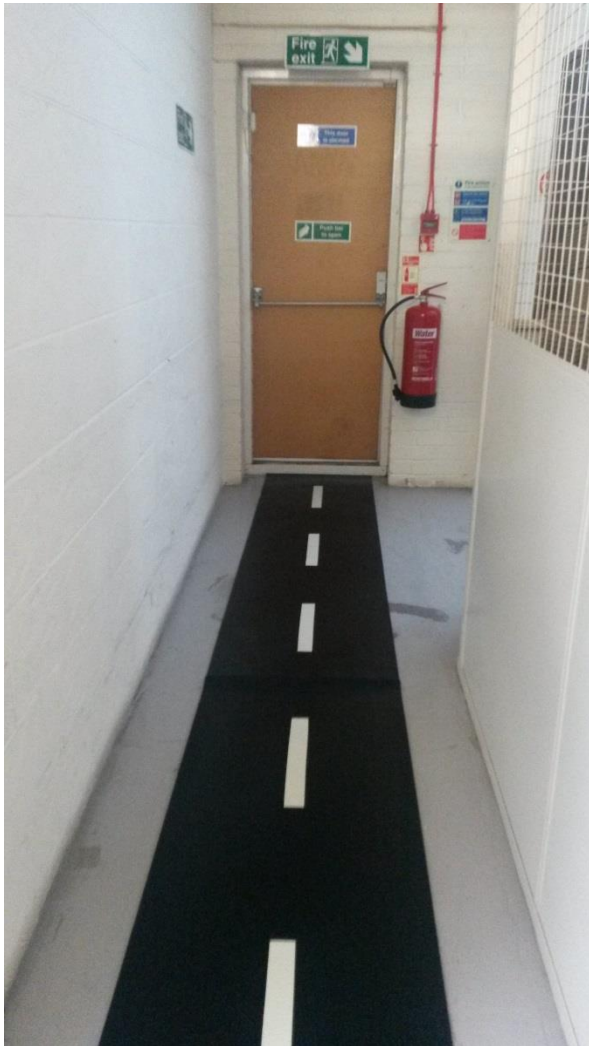

TELBAK Flexible black PVC matting is resistant to a wide range of chemicals (detailed list available on request); is resistant to attack by dilute acids at room temperature, although there may be some discolouration of the surface.

Aqueous solutions of alkalis such as ammonia, caustic potash and caustic soda do not attack Telbak except in high concentrations at elevated temperatures.

Telbak has greater resistance to oils than polythene, although exposure over several years will result in some softening and slight swelling. Some oils may contain additives which could affect Telbak.

Telbak is not attacked by the aqueous solutions of most inorganic compounds and similar formulations. It is not attacked by shampoos, photographic fixers and developers, or many disinfectants.

Telbak is not suitable for contact with chlorinated hydrocarbons, ketones, esters and ethers. Aliphatic hydrocarbons can be absorbed, and on subsequent drying can result in the material hardening and cracking. The effect of alcohols, such as ethyl and methyl alcohol, is similar.

The information contained in this document is correct to the best of our knowledge but results may vary depending on the conditions under which the material is used and consequently recommendations are made without warranty or guarantee.

Details of our standard product size is given in this information sheet, however please note that we are able to offer a variety of floor matting incorporating Telglow photoluminescent path finding strip.